



# Social Innovation for empowerment

## Dr Yanki Lee

15 Oct 2016 @ Commission for Poverty Summit



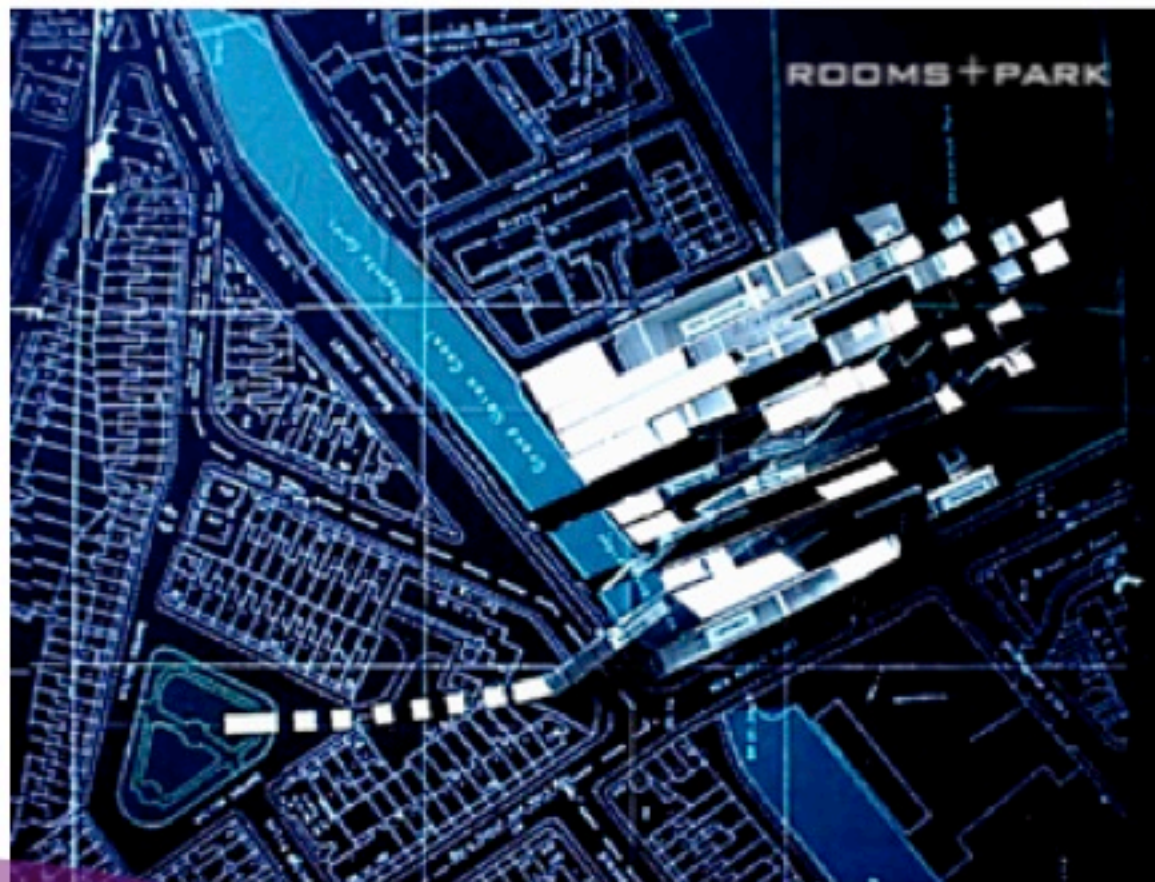

英國皇家藝術學院  
建築學畢業生



**Royal College of Art**  
Postgraduate Art and Design

This web-based resource has been created by the Helen Hamlyn Centre for Design at the Royal College of Art to share ways to design with people. Get started by meeting real people and exploring a range of activities of daily living. On this site you can review design methods, develop protocols for ethical practice and contribute your own ideas.

We welcome your participation, please contribute to this website here...

Home

People

Activities

Methods

Ethics

Contribute

Home

About

The Methods Lab

Ethos

Team

Contact

## Getting Started



### People

Meet real people who represent a range of capability



### Activities

Explore insights drawn from daily living activities

## Practical Resources



### Methods

Choose the right research methods for your project

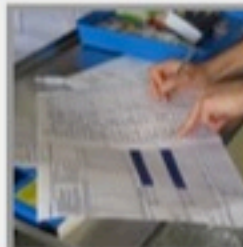

### Ethics

Your guide to the moral maze of ethical practice

設計  
方法論  
博士



# About HKDI (Hong Kong Design Institute):



HONG KONG  
DESIGN  
INSTITUTE  
香港知專  
設計學院

- Since 2010
- Directly funded by HK Government's Vocational Training Council
- Specialist college
- Strong links to industries



社會設計  
工作室

HKDI DESIS LAB

for social design  
research

天  
皇

HONG KONG  
DESIGN  
INSTITUTE

香港知專  
設計學院

*Member of VTC Group*  
VTC 機構成員

**Since July 2013 –  
Designers as enablers for societal changes**





# 1. Medical Model of Social Issues

**Sympathy**





A photograph of a park scene. In the foreground, a man wearing a white short-sleeved shirt, blue trousers, and a white hat is riding a bicycle on a paved path. He is looking towards the right. In the background, a woman in a pink shirt and light green pants is walking with a small child in a white tank top and blue shorts. They are walking along a paved path that runs alongside a lake. The lake is surrounded by lush green trees and foliage. In the distance, a traditional Chinese building with a dark roof is visible. The overall atmosphere is peaceful and scenic.

## 2. Social Model of Social Issues

**Empathy**



### 3. Culture Model of Social Issues

Ingenuity





# ingenuity

[in-juh-**noo**-i-tee, -**nyoo**-]

Spell

Syllables

# 創造力

[Examples](#)

[Word Origin](#)

noun, plural **ingenuities** for 3.

1. the quality of being cleverly inventive or **resourceful**; inventiveness:  
*a designer of great ingenuity.*
2. cleverness or skillfulness of conception or design:  
*a device of great ingenuity.*
3. an **ingenious** contrivance or device.
4. *Obsolete, ingenuousness.*

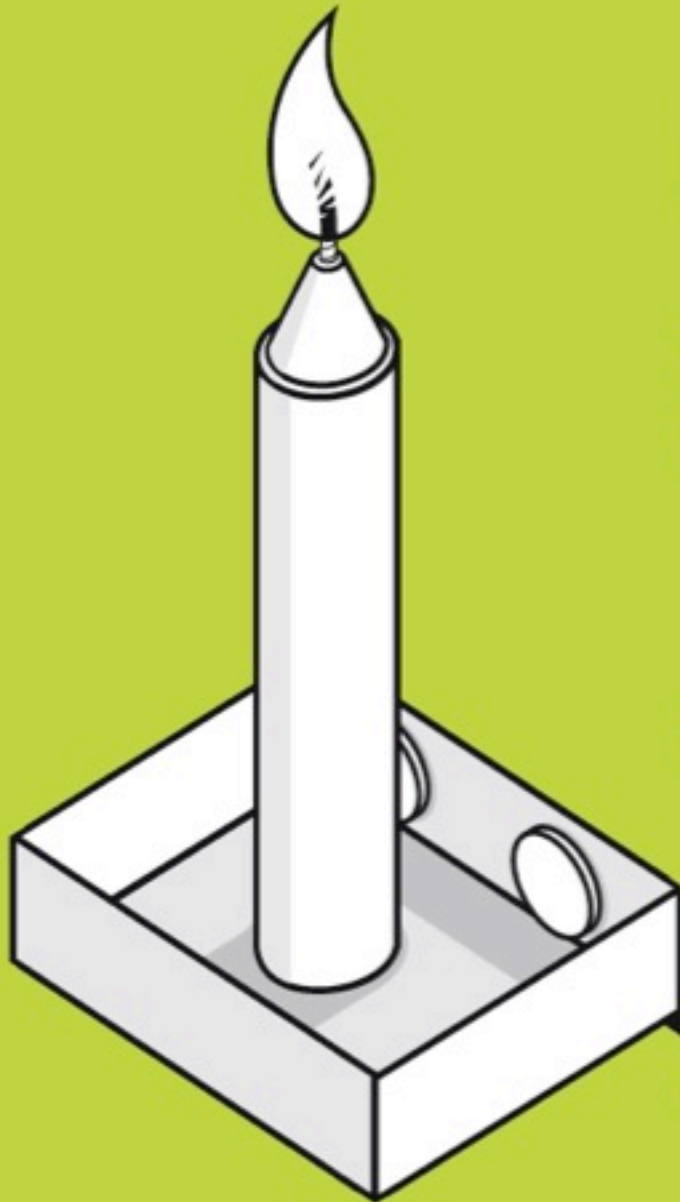

**Ingenuity =**

- 1. Recognise resources**
- 2. Combining these resources in a surprising way**
- 3. Use these resources to solve some practical problem**

**(RSA 2011)**





# Ingenious Britain

**“The UK must unlock the talent of its entire populations if it is to become a nation recognised continually for innovation”**

**Sir James Dyson, 2010**



埋黎設計「老嘢」啦喂!

老嘢設計會



社會設計  
工作室  
HKDI DESIS LAB  
for social design  
research



Design Age HK Club



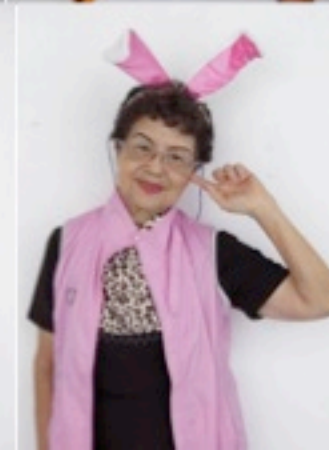



# 1. Immersing through empathising



The 银龄创造力  
Ingenuity of  
Ageing

for designing 黄金清华·银龄创新  
social innovation  
Yanki Lee 李成琪设计学博士



# The Scientist Study in China



Professor Ping-Pong



Professor Singing



Professor Green  
Ageing



Professor Silogans  
and Blogging



Professor Physics



Professor Oxygen



Professor English



Professor Style



Professor Work



**Designer in  
residency  
6 month @  
care homes**



## 2. Ideating through co-creating



# 社會設計 工作室

HKDI DESIS LAB

for social design  
research

## Launch of DesignAge HK Club @ Senior Expo 2014



### Come to design with us!

1. Tell/show us what type of bag are you using
2. Describe to us what is your dream bag
3. Design and create together your dream bag
4. Share the result to others

### 齊來參與設計!

1. 您係家用緊咩袋
2. 您覺得最理想嘅袋係點?
3. 設計並動手造一下您心目中最佳嘅袋
4. 俾其他人分享您嘅作品





# 社會設計 工作室

HKDI DESIS LAB

for social design  
research

## Launch of DesignAge HK Club @ Senior Expo 2014



### Come to design with us!

1. Describe to us a typical meal
2. Show us your designed meal
3. Start with utensils
4. Pick the food ingredients
5. Share with others

### 齊來參與設計!

1. 講俾我哋聽你日常用緊嘅餐
2. 分享你設計嘅一餐
3. 由餐具開始設計
4. 選擇適合你選用嘅食材
5. 再同大家分享



02

**Project 02/  
Open Homes II  
"Draw your home"  
with old and  
young citizens**



**Discipline/  
Interior Design  
and Architecture**

**Format/  
Citizens'  
workshop**

**Duration/  
Aug - Nov 2014**

**Outcome/  
Hong Kong citizens'  
perspectives  
of home from  
different  
generations**

**Person in charge/  
Albert Tsang &  
Rowena Ho**













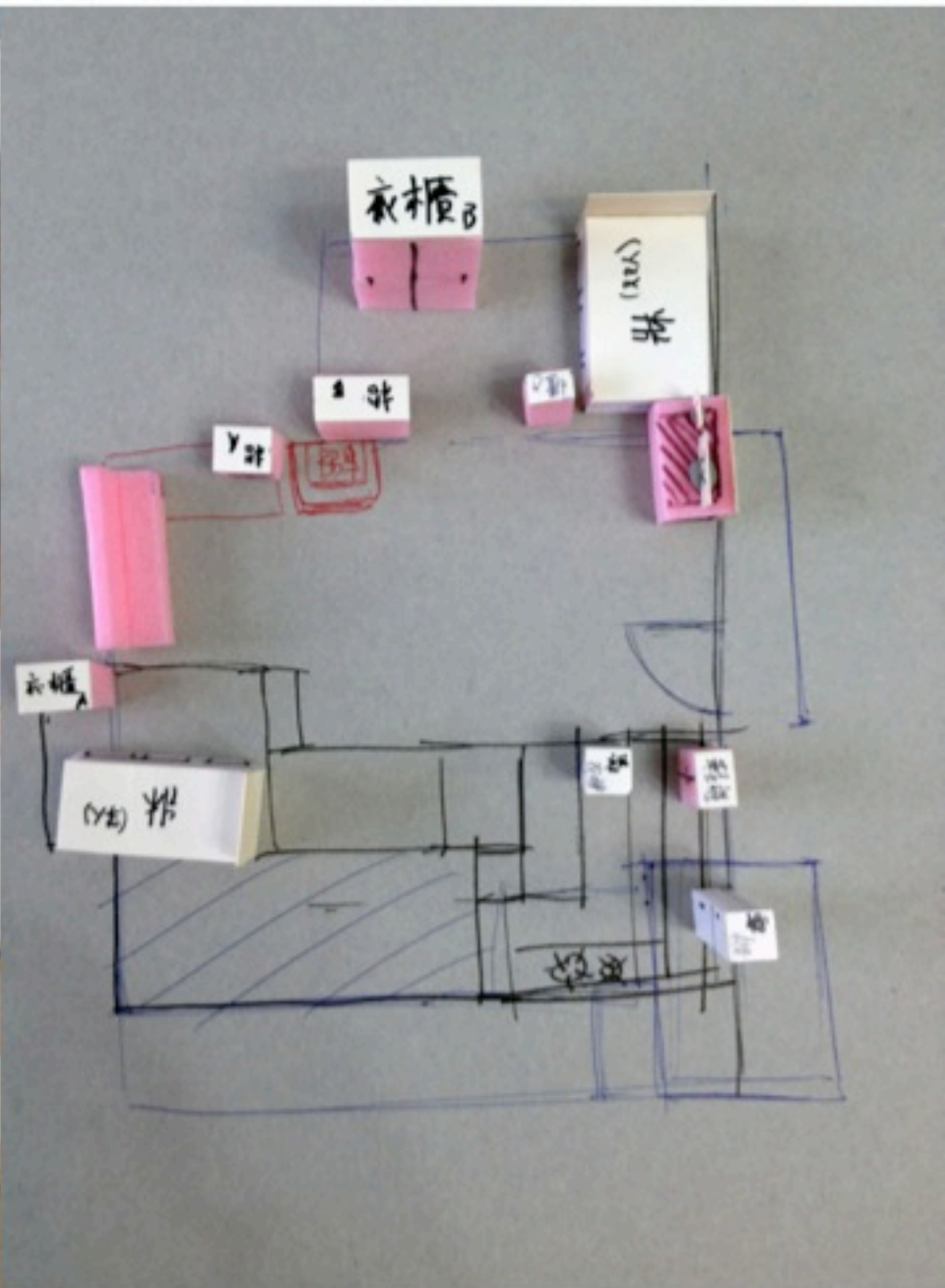







# REAL DESIGN

Designing with the real world & Re-imagining the everyday

SEPT 2013

# 01



MEMBER OF THE GROUP  
VTC 成員

Welcome to the first issue of REAL DESIGN, a newsletter by the HKDI Design Lab for Social Design Research (香港知識設計學院 社會設計工作室), a non-commercial/philanthropic research group of the Hong Kong Design Institute (HKDI) of the Vocational Training Council (VTC), founded in summer 2012. Using the motto 'Local Actions and Global Thinking' and '設計與生活', our aim is to set up a research platform of social design, an emerging field that advocates a new approach to design: 'designers as enablers of social change'. It is part of the DESIS International Network (Design for Social Innovation and Sustainability (社會創新與可持續設計國際聯盟)) collaborating with over 40 DESIS labs around the world. The network aims to advance international knowledge in design for the social good and develop social design practice to benefit the Hong Kong society.



## Possible Studies (設計可能研究)

### 3. Intervention through prototyping



# Open Minds

Possible Study of

# DEMENTIA

Design Magic and Demented Objects

HKDI

HONG KONG  
DESIGN  
INSTITUTE  
香港 知專  
設計學院

Member of VTC Group  
VTC 成員機構



ODF

[www.hkdi.edu.hk/opendesignforum](http://www.hkdi.edu.hk/opendesignforum)

## Project 20/ Open Dementia City and tools with Don Mak



Open Dementia  
mapping and the  
dementia character.

The Open Dementia project is a project commissioned by the Jockey Club Centre for Positive Ageing to improve their public awareness programme about dementia through design. Instead of just explaining dementia as a medical issue, as design researchers, we decided to rethink the way to get citizens to experience dementia through the social model of disability. According to SCOPE, UK's leading disability charity, 'The social model of disability says that disability is caused by the way society is organised, rather than by a person's impairment or difference.' We took this viewpoint as the starting point and collaborated with illustrator Don Mak to visualise the common symptoms of dementia in a city map by asking a simple question:

*'What if the whole city has dementia?'*

Thus, the lab designed a set of "dementia experience tools" that redesigned everyday objects allowing participants to experience the life of a person with dementia. The aim is to bring empathy to the participants. The whole set consists of 11 different dementing-objects, each one corresponding to a specific symptom of dementia. The final tools were developed through a series of codesign workshops with occupational therapists, social workers, researchers and managing personnel at the centre.

Person in charge/  
Louise Wong, Greta  
Kwok & Cynil Lee

Outcome/  
Open Dementia  
City map for  
awareness  
experience tools

Duration/  
July - Dec 2015

Format/  
Design research  
project

Discipline/  
Design  
Research,  
Communication  
and Product  
Design





*The 11 Dementia Experience Tools/  
Dementing-objects.*

*"A lot of people with dementia have communication barriers or mood problems therefore understanding the disease process and knowing the special communication skills are important."*

*- Nancy Tang  
Occupational Therapist I, Head of Rehabilitation  
Services and Senior Training Consultant,  
Jockey Club Centre for Positive Ageing, Hong Kong*

## Open Minds

*Dementing  
object - a never-  
buttoned shirt.*



*Photo credit:  
Ho Yin of A nice  
place to*



Photo credit:  
Ho Yin of A nice  
place to



Dementia experience  
objects:  
a tricky calculator (top)  
and misusing glues  
(bottom)

Prototype testing  
with HKDI Product  
Design students



# Open Minds

Possible Study of

# DEATH

Design Living and Dying

**HKDI**

HONG KONG  
DESIGN  
INSTITUTE  
香港知專  
設計學院

Member of VTC Group  
VTC 機構成員



ODF

[www.hkdi.edu.hk/opendesignforum](http://www.hkdi.edu.hk/opendesignforum)

# 設計 生與死

## HKDI DESIS Lab Design Possible Study #1 LIVING & DYING

死  
DYING

DEAD

ALIVE

生  
LIVING

殯  
HEARSING

葬  
BURIAL

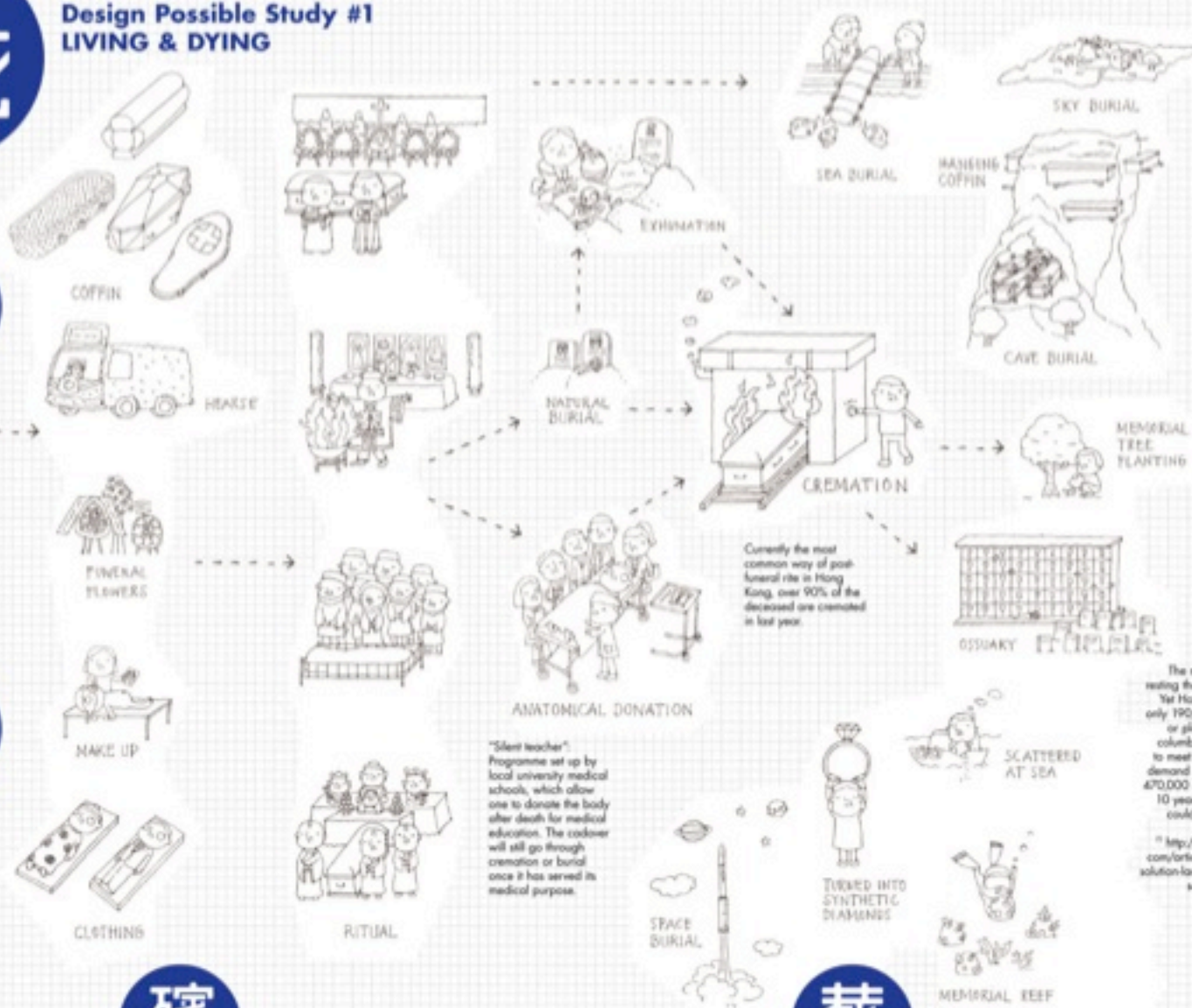

The major way of resting the ashes now. Yet Hong Kong has only 190,000 existing or planned public columbarium niches to meet an expected demand of more than 470,000 over the next 10 years<sup>18</sup>. Yet there could be so many alternatives.  
<sup>18</sup> <http://www.scmp.com/article/099260/solution-lack-urn-niches-sorely-needed>



How can design actions enable people to have positive responses to their own death?











A PURE DIALOGUE



Let's co-design our dying issues  
共同設計我們的死亡

死過界  
F  
I  
N  
G  
D  
Y  
N  
E

©2015 DSDI, Lab for Social Design, Research & Urban Change  
Landscape, E2D, Service, Culture & DSDI design studio in Hong Kong  
香港城市大學設計學院、社會設計工作室與城市變遷研究中心、第一專業研究中心與設計學院共同合作

# OPEN DIAMOND PROJECT

## 設計"死"粒石

Design your  
dying matters

設計  
生與  
死

### Come to design with us!

Have you ever think where are your ashes will become after your death? If you want to become "a diamond", we would like to invite you to join us for a co-design jewellery process about your own dying matters.

Open Diamond is an extended project from Fine Dying (2013) Possible Study of Living and Dying conducted by HKDI DESIS Lab for Social Design Research.

### 一齊設計<死嘢>!

有冇試過人死後嘅骨灰都可以做鑽石? 如果有興趣嘅話,不妨埋嚟一齊設計你心目中一顆代表你嘅鑽石喇!

<設計"死"粒石>計劃是一個由香港知專設計學院社會設計工作室所進行的<設計生與死>之死過界 (2013) 的研究下延伸的一項研究項目







# Design for Open Enquiry

Dying  
Supplier  
死亡供应者

Living  
Receiver  
活着的接收者

Jewelry  
Designer  
死亡珠宝  
设计师



TURNED IN  
SYNTHETIC  
DIAMONDS

Diamond Pod \_  
a conflict space  
for intergenerational  
conversion about  
death





Death Jewellery  
Collection



SOCIAL DESIGN + ACTION RESEARCH



啟創  
民社

ENABLE  
FOUNDATION

HKDI

HONG KONG  
DESIGN  
INSTITUTE  
香港智專  
設計學院

Member of VTC Group  
VTC 成員機構



# Culture Model of Social Issues

**Dr Yanki Lee MA(RCA)**

[www.yankilee.com](http://www.yankilee.com)

[www.hkdi.desislabs.com](http://www.hkdi.desislabs.com)

[vtc.edu.hk](http://vtc.edu.hk)